

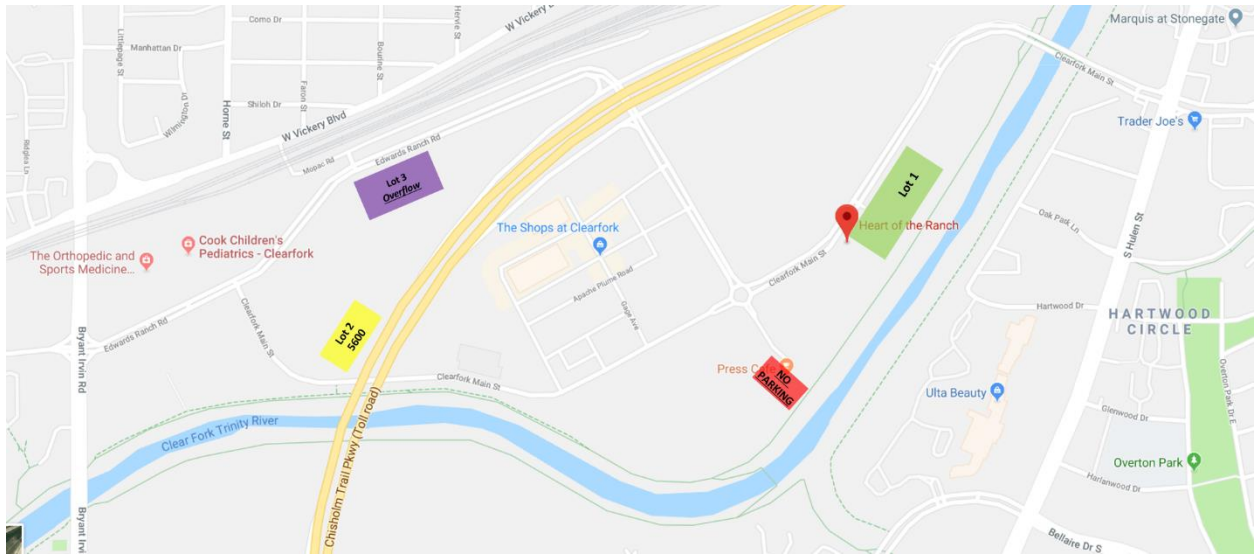

The Blast Parking

Due to road closures for the race please follow the below parking instructions.

- **Before** to 7:30am all parking will be directed to **Heart of the Ranch Parking Lot 1:**
 - 5000 Clearfork Main, Fort Worth, TX 76109
- **After** 7:30am, due to street closures, please follow the following routes to parking:
 - Entering from Bryant Irvin going east Edwards Ranch Road
 - Turn Right at Clearfork Main Street
 - Proceed to **Lot 2 – 5600 Clearfork Main** parking lot for shuttle parking
 - **Lot 2** – 5600 Clearfork Main Street, Fort Worth, TX 76109
 - Entering Clearfork from Chisholm Trail Toll Road
 - Turn south and proceed to round-about
 - Take first right onto Clearfork Main Street from the round about
 - Proceed to **Lot 2 - 5600 Clearfork Main** parking lot for shuttle parking
 - **Lot 2** – 5600 Clearfork Main Street, Fort Worth, TX 76109
 - Entering from Hulen Street
 - Turn West on Clearfork Main Street
 - Turn left at the **Lot 1 - Heart of the Ranch** Parking Lot
- **Lot 3: Overflow parking only**
 - Off Edwards Ranch Road



Bike Ride Parking:

- All cyclist should park at Acme Brick
3024 Acme Brick Plaza
Fort Worth, TX 76109
- Take an easy warm up ride east on the trail to Mellow Johnny's Bike Shops, where the 30-mile bike ride will begin.
 - The ride begins at 7:30am from Mellow Johnny's Bike Shop
- **NO event parking will be allowed at Mellow Johnny's or The Trailhead.**

